

PLAN

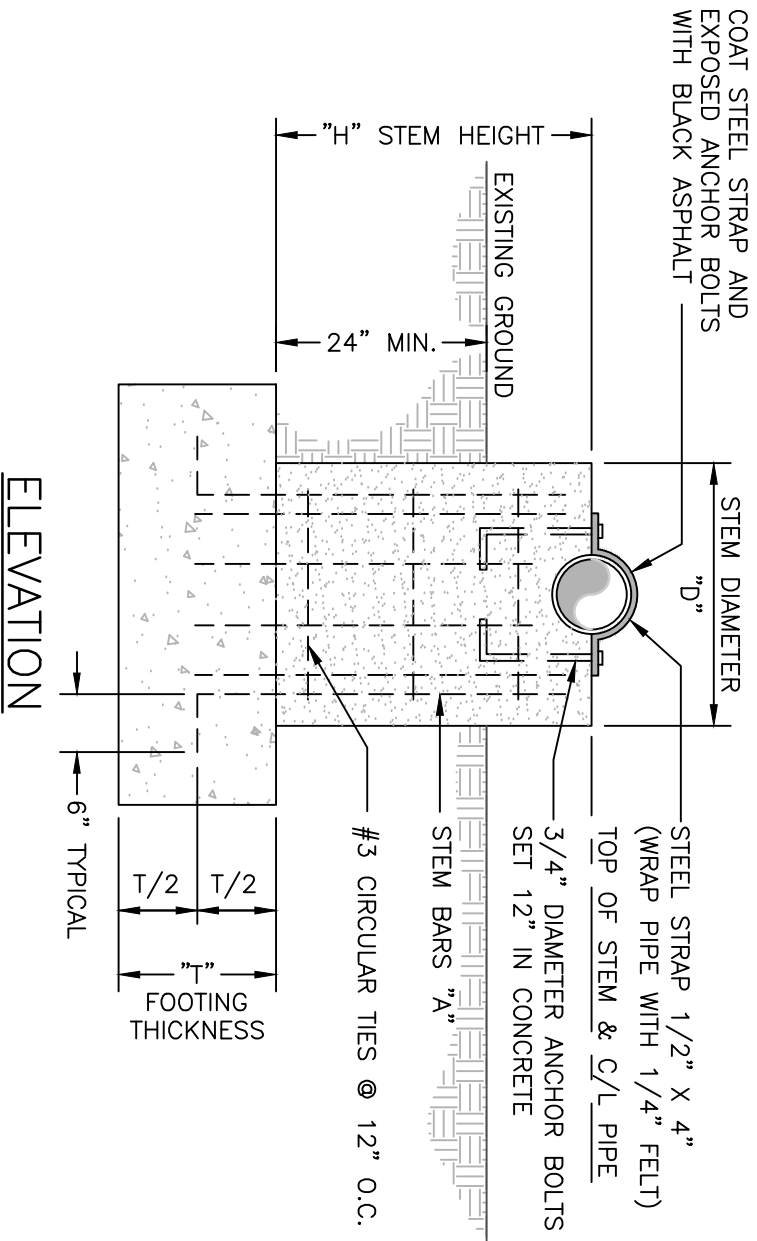

ELEVATION

LOCATE PIPE JOINT AS CLOSE TO PIER AS POSSIBLE

3" CLEAR

STEM BARS "A"

CENTERLINE FOOTING AND PIER

#3 CIRCULAR TIES @ 12" O.C.

CENTERLINE FOOTING, STEM, AND PIPE

COAT STEEL STRAP AND EXPOSED ANCHOR BOLTS WITH BLACK ASPHALT

STEM DIAMETER "D"

STEEL STRAP 1/2" X 4" (WRAP PIPE WITH 1/4" FELT)

TOP OF STEM & C/L PIPE

3/4" DIAMETER ANCHOR BOLTS SET 12" IN CONCRETE

STEM BARS "A"

#3 CIRCULAR TIES @ 12" O.C.

FOOTING THICKNESS

6" TYPICAL

T/2 T/2

NOTES:

1. AN ALTERNATE DESIGN MAY BE SUBMITTED BY THE ENGINEER

PIPE SUPPORT PIER FOR DRY LAND CROSSING

5.09.1

2020	TCZ	CREATED
5/28/22	BGM	CHANGE FONT, TITLE BLOCK
DATE	BY	DESCRIPTION

